

EVERY
STEP OF
THE WAY

PROPERTY GROUP

The Straight Mile Land



Contact us

www.everystepoftheway.net
info@everystepoftheway.net
0333 577 0118

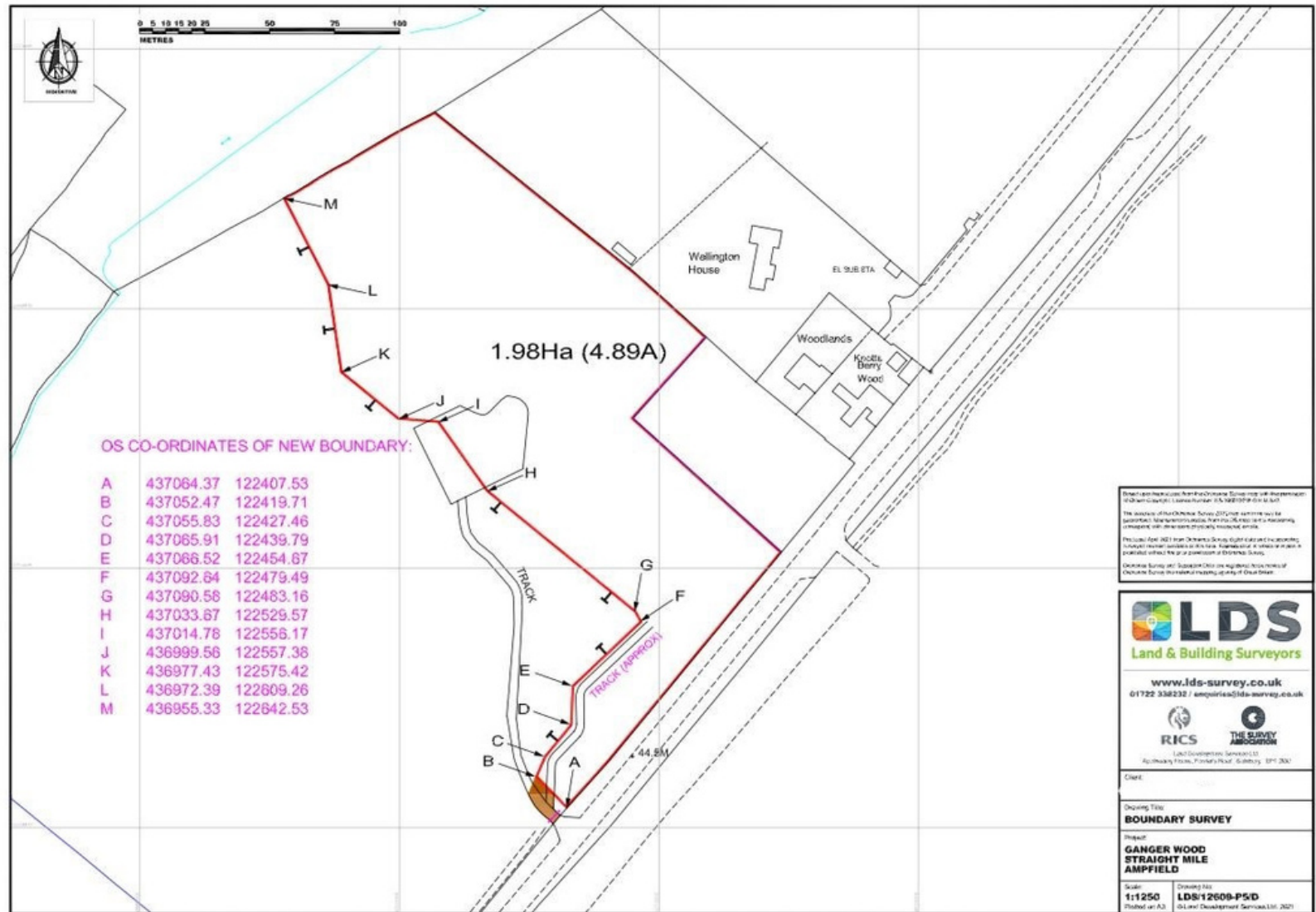

Land for Sale



An attractive block of approximately 1.80 Hectares/4.45 Acres of mature woodland and an open hard standing/clearing area, which is approximately half an acre. Situated in one of Romsey's most prestigious locations, on The Straight Mile. Viewings are strictly by appointment via Every Step of The Way Property Group.



The land offers well-maintained woodland. There is a gated entrance off The Straight Mile that opens to a track, which leads to an open hard standing, level clearing area of approximately half an acre, which in turn leads to tracks that run a circle around the lands boundaries, through the woodland.

SERVICES

There is currently no services.

RIGHTS OF WAY

The land is sold subject to and with the benefit of all matters contained in or referred to in the title deeds together with all public or private rights of way, wayleaves, easements and other rights of way. There are no public rights of way crossing the land.

TENURE & POSSESSION

The land is being offered for sale on a freehold basis with vacant possession.





DIRECTIONS

From Romsey proceed towards Winchester on A309. Upon entering the stretch of The Straight Mile, the gate and land access can be located on the left hand side, indicated by our for-sale board.

